



# RedBag Accessibility Conformance Report

## WCAG Edition

(Based on VPAT® Version 2.5)

**Name of Product / Version:** RedBag

**Report Date:** 01 January 2025

**Product Description:** RedBag is a cloud-based communication software that provides communication in and out of rooms during an emergency situation in addition to emergency supply inventory management.

**Contact Information:**

- Dan Doerr - Security Advisor and Implementation Specialist
- 303-408-6023
- ddoerr@getredbag.com

**Evaluation Methods Used:**

- Tested using Silktide Web Accessibility, based on the WCAG 2.2. compliance standards.

### Application Standards / Guidelines:

“WCAG 2.2 extends Web Content Accessibility Guidelines 2.1 (WCAG 2.1), which was published as a W3C Recommendation June 2018. Content that conforms to WCAG 2.2 also conforms to WCAG 2.0 and WCAG 2.1.” – World Wide Web Consortium (W3C).

Standard / Guideline	Included in Report
Web Content Accessibility Guidelines 2.2	Level A (Yes / No) Level AA (Yes / No) Level AAA (Yes / No)

### Terms:

The terms used in the Conformance Level information are defined as follows:

- **Supports:** The functionality of the product has at least one method that meets the criterion without known defects or meets with equivalent facilitation.
- **Partially Supports:** Some functionality of the product does not meet the criterion.
- **Does Not Support:** The majority of the product functionality does not meet the criterion.
- **Not Applicable:** The criterion is not relevant to the product.

- **Not Evaluated:** The product has not been evaluated against the criterion. This can only be used in WCAG Level AAA criteria.

## WCAG 2.2 Report

**Note:** When reporting on conformance with the WCAG 2.2 Success Criteria, they are scoped for full pages, complete processes, and accessibility-supported ways of using technology as documented in the WCAG 2.2 Conformance Requirements.

### **Summary:**

RedBag has taken strides to ensure that the *Classroom Perspective: Safety Audit Page* will be compliant with CO HB 21-1110 and conform to WCAG 2.2. by the extended deadline of July 1, 2025.

As of 01 January, 2025, RedBag is in the process of ensuring that this page aligns with WCAG 2.2. and is compliant with CO HB 21-1110. We anticipate compliance within 60 days of this report.

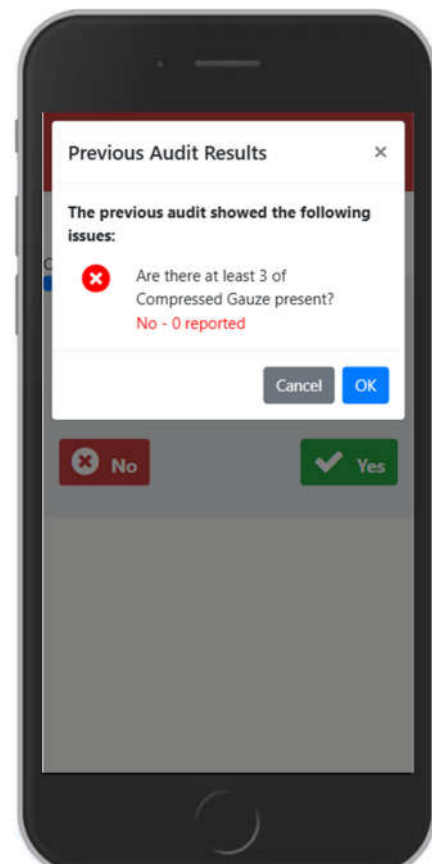
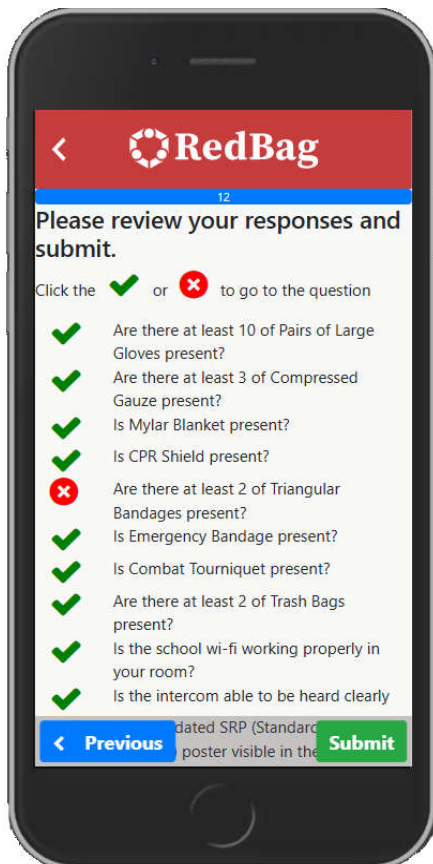
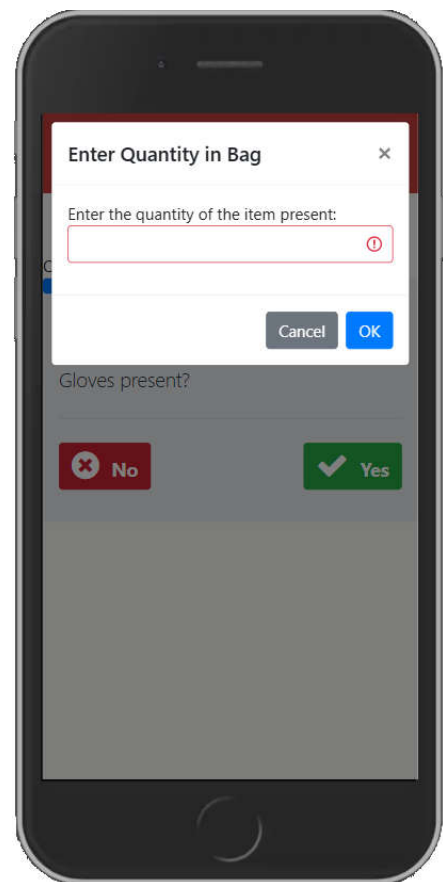
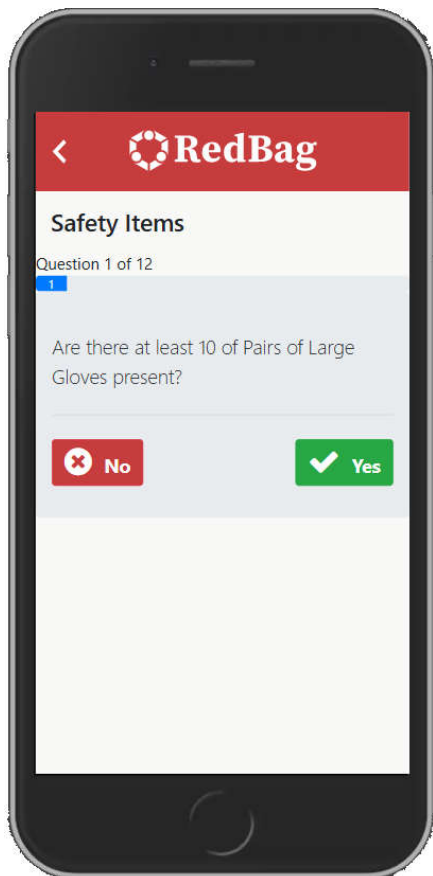

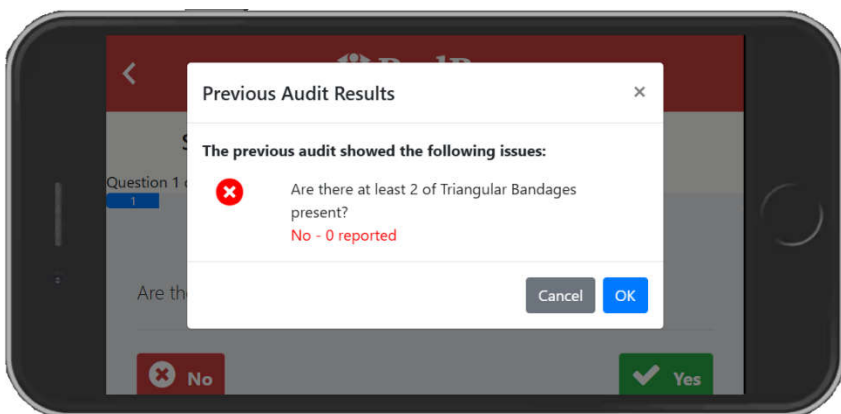
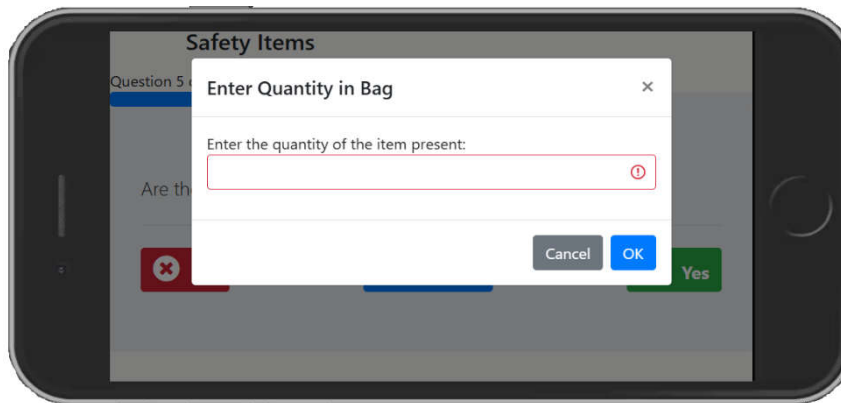
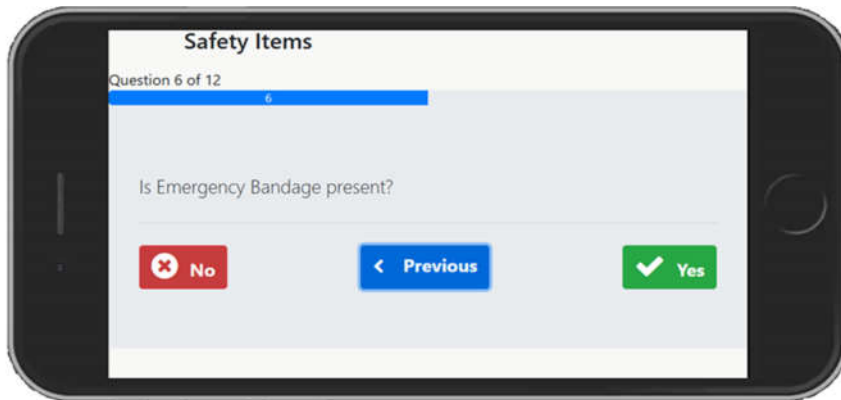

Table 1: Success Criteria, Level A

Notes: RedBag Classroom Perspective, Safety Audit / Inventory – Manual Test

Criteria	Conformance Level	Remarks and Explanations
1.1.1. Non-Text Content	Not Applicable	
1.2.1. Audio-Only and Video-Only (Prerecorded)	Not Applicable	
1.2.2. Captions (Prerecorded)	Not Applicable	
1.2.3. Audio Description or Media Alternative (Prerecorded)	Not Applicable	
1.3.1. Information and Relationships	Supports	1. Information, structure, and relationships conveyed through presentation can be programmatically determined or are available in text.
1.3.2. Meaningful Sequence	Not Applicable	
1.3.3. Sensory Characteristics	Supports	1. As a user checks in, there are multiple cues that relate to performing an action or that are intended to draw the user's attention, including visual cues, color, and the use of check boxes.
1.4.1. Use of Color	Supports	1. Color is not used as the only visual means of conveying information, indicating an action, prompting a response, or distinguishing a visual element.
1.4.2. Audio Control	Not Applicable	
2.1.1. Keyboard	Supports	1. All functionality of the content is operable through a keyboard interface without requiring specific timings for individual keystrokes.
2.1.2. No Keyboard Trap	Supports	<ol style="list-style-type: none"> <li>1. If keyboard focus can be moved to a component of the page using a keyboard interface, then focus can be moved away from that component using only a keyboard interface, and, if it requires more than unmodified arrow or tab key or other standard exit methods, the user is advised of the method for moving focus away.</li> <li>2. RedBag has recognized a previous keyboard trap when focusing on various aspects of the check-in process. This issue has since been remedied to</li> </ol>

		comply with the above mentioned.
2.1.4. Character Key Shortcuts	Not Applicable	
2.2.1. Timing Adjustable	Not Applicable	
2.2.2. Pause, Stop, Hide	Supports	<ol style="list-style-type: none"> <li>For moving, blinking, scrolling, or auto-updating information, all of the following are true: <ul style="list-style-type: none"> <li>For any moving, blinking or scrolling information that (1) starts automatically, (2) lasts more than five seconds, and (3) is presented in parallel with other content, there is a mechanism for the user to pause, stop, or hide it unless the movement blinking, or scrolling is part of an activity where it is essential.</li> <li>For any auto-updating information that (1) starts automatically and (2) is presented in parallel with other content, there is a mechanism for the user to pause, stop, or hide it or control the frequency of the update unless the auto-updating is part of an activity where it is essential.</li> </ul> </li> </ol>
2.3.1. Three Flashes or Below Threshold	Supports	<ol style="list-style-type: none"> <li>Web pages do not contain anything that flashes more than three times in any one second period, or the flash is below the general flash and red flash thresholds.</li> </ol>
2.4.1. Bypass Blocks	Not Applicable	
2.4.2. Page Titled	Supports	<ol style="list-style-type: none"> <li>Web pages have titles that describe topic or purpose.</li> </ol>
2.4.3. Focus Order	Supports	<ol style="list-style-type: none"> <li>If a Web page can be navigated sequentially and the navigation sequences affect meaning or operation, focusable components receive focus in an order that preserves meaning and operability.</li> </ol>
2.4.4. Link Purpose (In Context)	Supports	<ol style="list-style-type: none"> <li>The purpose of each link can be determined from the link text alone or from the link text together with its programmatically determined link context, except where the purpose of the link would be ambiguous to users in general.</li> </ol>
2.5.1. Pointer Gestures	Supports	<ol style="list-style-type: none"> <li>All functionality that uses multipoint or path-based gestures for operation can be</li> </ol>

		operated with a single pointer without a path-based gesture, unless a multipoint or path-based gesture is essential.
2.5.2. Pointer Cancellation	Supports	<ol style="list-style-type: none"> <li>For functionality that can be operated using a single pointer, at least one of the following is true: <ul style="list-style-type: none"> <li>No Down-Event – The down-event of the pointer is not used to execute any part of the function.</li> <li>Abort or Undo – Completion of the function is on the up-event, and a mechanism is available to abort the function before completion or to undo the function after completion.</li> <li>Up Reversal – The up-event reverses any outcome of the proceeding down-event.</li> <li>Essential – Completing the function on the down-event is essential.</li> </ul> </li> </ol>
2.5.3. Label in Name	Supports	<ol style="list-style-type: none"> <li>For user interface components with labels that include text or images of text, the name contains the text that is presented visually.</li> </ol>
2.5.4. Motion Actuation	Not Applicable	
3.1.1. Language of Page	Supports	<ol style="list-style-type: none"> <li>The default human language of each Web page can be programmatically determined.</li> </ol>
3.2.1. On Focus	Supports	<ol style="list-style-type: none"> <li>When any user interface component receives focus, it does not initiate a change of context.</li> </ol>
3.2.2. On Input	Supports	<ol style="list-style-type: none"> <li>Changing the setting of any user interface component does not automatically cause a change of context unless the user has been advised of the behavior before using the component.</li> </ol>
3.2.6. Consistent Help	Not Applicable	
3.3.1. Error Identification	Not Applicable	
3.3.2. Labels or Instructions	Supports	<ol style="list-style-type: none"> <li>Labels or instructions are provided when content requires user input.</li> </ol>
3.3.7. Redundant Entry	Not Applicable	
4.1.1. Parsing (Obsolete and Removed)	Not Applicable	

Table 2: Success Criteria, Level AA

Notes: RedBag Classroom Perspective, Training Mode Landing Page

Criteria	Conformance Level	Remarks and Explanations
1.2.4. Captions (Live)	Not Applicable	
1.2.5. Audio Description (Prerecorded)	Not Applicable	
1.3.4. Orientation	Supports	1. Content does not restrict its view and operation to a single display orientation, such as portrait or landscape, unless a specific display orientation is essential.
1.3.5. Identify Input Purpose	Not Applicable	
1.4.3. Contrast (Minimum)	Supports	<ol style="list-style-type: none"> <li>The visual presentation of text and images of text has a contrast ratio of at least 4:5:1, except for the following: <ul style="list-style-type: none"> <li>Large Text (18 point or 14 point bold) – Large-scale text and images of large-scale text have a contrast ratio of at least 3:1.</li> <li>Incidental – Text or images that are part of an inactive user interface component, that are pure decoration, that are not visible to anyone, or that are part of a picture that contains significant other visual content, have no contrast requirement.</li> <li>Logotypes – Text that is part of a logo or brand name has no contrast requirement.</li> <li>RedBag has recognized that this page has not previously met contrast requirements but has made the necessary changes to become ADA compliant.</li> </ul> </li> </ol>
1.4.4. Resize Text	Supports	1. Except for captions and images of text, text can be resized without assistive technology up to 200 percent without loss of content or functionality.
1.4.5. Images of Text	Supports	<ol style="list-style-type: none"> <li>If the technologies being used can achieve the visual presentation, text is used to convey information rather than images of text except for the following: <ul style="list-style-type: none"> <li>Customizable – The image of the text can be visually customized to the user's requirements.</li> </ul> </li> </ol>

		<ul style="list-style-type: none"> <li>• Essential – A particular presentation of text is essential to the information being conveyed.</li> </ul>
1.4.10. Reflow	Supports	<ol style="list-style-type: none"> <li>1. Content can be presented without loss of information or functionality, and without requiring scrolling in two dimensions for: <ul style="list-style-type: none"> <li>• Vertical scrolling content at a width equivalent to 320 CSS pixels.</li> <li>• Horizontal scrolling content at a height equivalent to 256 CSS pixels.</li> </ul> </li> <li>2. Except for parts of the content which require two-dimensional layout for usage or meaning.</li> </ol>
1.4.11. Non-Text Contrast	Supports	<ol style="list-style-type: none"> <li>1. The visual presentation of the following have a contrast ratio of at least 3:1 against adjacent color(s): <ul style="list-style-type: none"> <li>• User Interface Components – Visual information that is required to identify user interface components and states, except for inactive components or where the appearance of the component is determined by the user agent and not modified by the author.</li> <li>• Graphical Objects – Parts of graphical required to understand the content, except when a particular presentation of graphics is essential to the information being conveyed.</li> </ul> </li> </ol>
1.4.12. Text Spacing	Supports	<ol style="list-style-type: none"> <li>1. In content implemented using markup languages that support the following text style properties, no loss of content or functionality occurs by setting all of the following and by changing no other style property: <ul style="list-style-type: none"> <li>• Line height (line spacing) to at least 1.5 times the font size.</li> <li>• Spacing following paragraphs to at least 2 times the font size.</li> <li>• Letter spacing (tracking) to at least 0.12 times the font size.</li> <li>• Word spacing to at least 0.16 times the font size.</li> </ul> </li> </ol>
1.4.13. Content on Hover or Focus	Supports	<ol style="list-style-type: none"> <li>1. Where receiving and then removing the pointer hover or</li> </ol>

		<p>keyboard focus triggers additional content to become visible and then hidden, the following are true:</p> <ul style="list-style-type: none"> <li>• Dismissible – A mechanism is available to dismiss the additional content without moving point hover or keyboard focus, unless the additional content communicates an input error or does not obscure or replace other content.</li> <li>• Hover-able – If pointer hover can trigger the additional content, then the pointer can be moved over the additional content without the additional content disappearing.</li> <li>• Persistent – The additional content remains visible until the hover or focus trigger is removed, the user dismisses it, or its information is no longer valid.</li> </ul>
2.4.5. Multiple Ways	Supports	1. More than one way is available to locate a Web page within a set of Web pages except where the Web page is the result of, or a step in, a process.
2.4.6. Headings and Labels	Supports	1. Headings and labels describe topic or purpose.
2.4.7. Focus Visible	Supports	1. Any keyboard operable user interface has a mode of operation where the keyboard focus indicator is visible.
2.4.11. Focus Not Obscured (Minimum)	Supports	1. When a user interface component receives keyboard focus, the component is not entirely hidden due to author-created content.
2.5.7. Dragging Movement	Not Applicable	
2.5.8. Target Size (Minimum)	Supports	<p>1. The size of the target for point inputs is at least 24 by 24 CSS pixels, except where:</p> <ul style="list-style-type: none"> <li>• Spacing – Undersized targets (those less than 24 by 24 CSS pixels) are positioned so that if a 24 CSS pixel diameter circle is centered on the bounding box of each, the circles do not intersect another target or the circle for another undersized target.</li> </ul>

		<ul style="list-style-type: none"> <li>• Equivalent – The function can be achieved through a different control on the same page that meets this criterion.</li> <li>• Inline – The target is in a sentence, or its size is otherwise constrained by the line-height of non-target text.</li> <li>• User Agent Control – The size of the target is determined by the user agent and is not modified by the author.</li> <li>• Essential – A particular presentation of the target is essential or legally required for the information being conveyed.</li> </ul>
3.1.2. Language of Parts	Supports	<ol style="list-style-type: none"> <li>1. The human language of each passage or phrase in the content can be programmatically determined except for proper names, technical terms, words of indeterminate language, and words or phrases that have become part of the vernacular of the immediately surrounding text.</li> </ol>
3.2.3. Consistent Navigation	Not Applicable	
3.2.4. Consistent Identification	Supports	<ol style="list-style-type: none"> <li>1. Components that have the same functionality within a set of Web pages are identified consistently.</li> </ol>
3.3.3. Error Suggestion	Not Applicable	
3.3.4. Error Prevention (Legal, Financial, Data)	Not Applicable	
3.3.8. Accessible Authentication (Minimum)	Not Applicable	
4.1.3. Status Messages	Supports	<ol style="list-style-type: none"> <li>1. In content implementation using markup languages, status messages can be programmatically determined through role or properties such that they can be presented to the user by assistive technologies without receiving focus.</li> </ol>